

PUNZÓN CABEZA CILÍNDRICA CON EXPULSOR SHOULDER PUNCH EJECTOR

833E

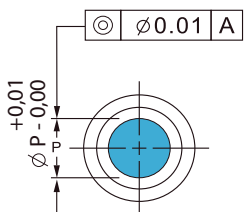

Ref. 833E

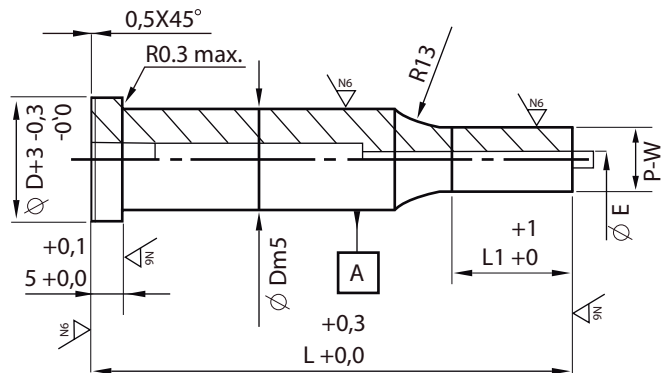

833E1

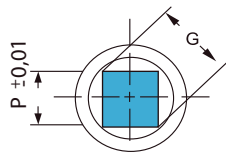

833E2

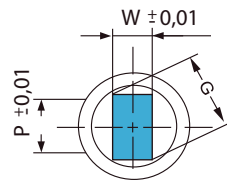

833E3

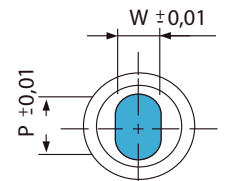

833E4

D	L1		P Redondo	Rango Figuras W min. P-G max.		L				
	Standard	Alternatives		70	80	90	100	125		
5	13	19 / 25	1,60 - 4,99	1,60	5,00	•	•	•	•	•
6	13	19 / 25	2,00 - 5,99	2,00	6,00	•	•	•	•	•
8	19	13 / 25	3,00 - 5,99	3,00	8,00	•	•	•	•	•
10	19	13 / 25	3,00 - 9,99	3,00	10,00	•	•	•	•	•
13	19	13 / 25	6,00 - 12,99	6,00	13,00	•	•	•	•	•
16	19	13 / 25	8,00 - 15,99	6,00	16,00	•	•	•	•	•
20	19	13 / 25	10,00 - 19,99	6,00	20,00	•	•	•	•	•
25	19	13 / 25	12,00 - 24,99	6,00	25,00	•	•	•	•	•
32	25	13 / 19	16,00 - 31,99	8,00	32,00	•	•	•	•	•
40	25	19 / 30	20,00 - 39,99	8,00	40,00	•	•	•	•	•
45	25	19 / 30	25,00 - 44,99	9,00	45,00	•	•	•	•	
50	25	19 / 30	30,00 - 49,99	10,00	50,00	•	•	•	•	
56	25	19 / 30	35,00 - 55,99	11,00	56,00	•	•	•	•	
63	25	19 / 30	40,00 - 62,99	12,00	63,00	•	•	•	•	

MATERIAL / MATERIAL:

HSS M2 1.3343 HRc 60 - 63
HWS A2 1.2379 HRc 58 - 62
ASP23 HRc 63 - 66

Fabricación en HSS salvo indicaciones.
Standard manufacture in HSS.

EJEMPLO DE PEDIDO / ORDER EXAMPLE:

Rpund/Redondoo 833E1- Ø13 P=12,1 L1=19 L=100 HSS
Form/Forma 833E4 - Ø13 P=11,7 W=6,2 L1=19 L=100 0° HSS

*Fabricamos bajo plano cualquier medida

*We are manufacture special dimensions according dwg